

## 5. Setting BOTTOM RAIL Favorite Position

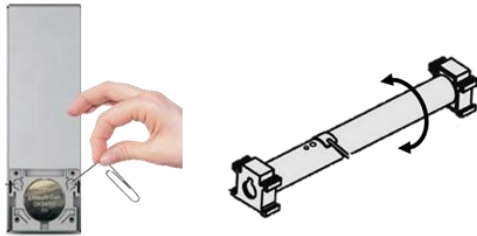

Press the **LEFT DOWN** or **LEFT UP** button to move the bottom rail to the desired favorite position.



Press **RIGHT PROGRAM BUTTON** on back of remote. Shade will jog once.

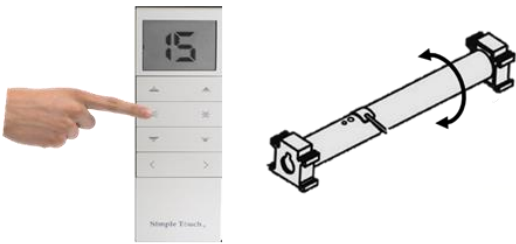

Press **LEFT STOP BUTTON** and the motor will jog again.

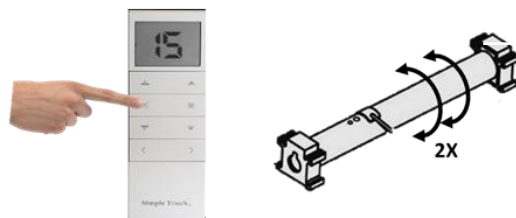

Press **LEFT STOP** button on remote until motor jogs twice.

**Note:** Channel "0" on the remote is the factory default "All" Button.

## 6. Setting MIDDLE RAIL Favorite Position

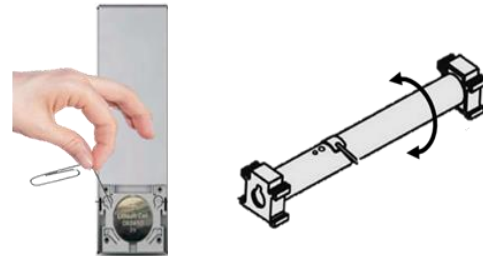

Press **LEFT PROGRAM BUTTON** on back of the remote, and the shade will jog.

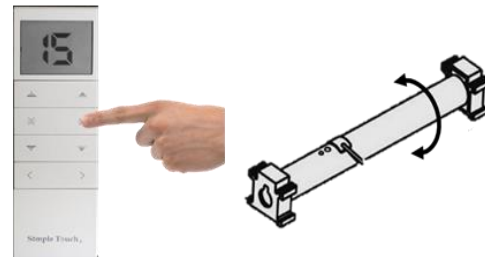

Press **RIGHT STOP** button until shade jogs.

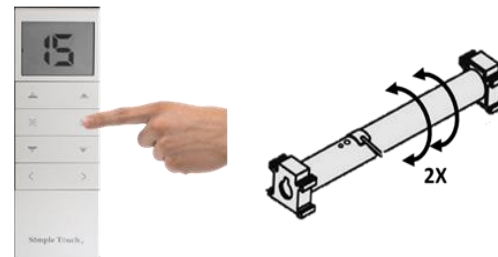

Press **RIGHT STOP** button on remote until motor jogs twice.

# HOME DECOR

WHOLESALE FABRICATORS

Made in America

## Simple Touch Motorized Cell Shade TOP-DOWN/BOTTOM-UP or DAY/NIGHT Set Up Guide

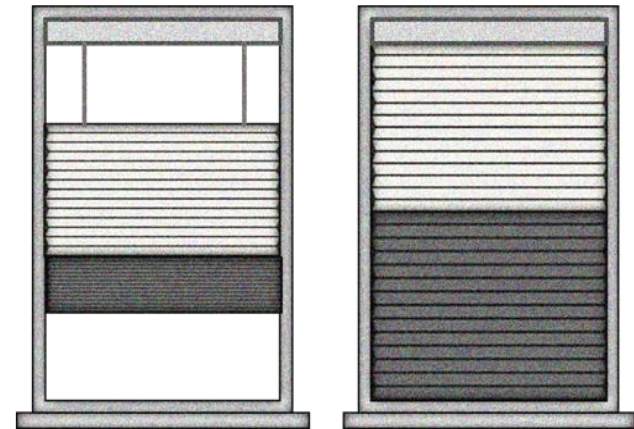

HOME DECOR WHOLESALE FABRICATORS  
602-995-9659



REV 050223

## 1. Connect Remote to Motor



Select appropriate channel to program pressing the LEFT and RIGHT buttons.

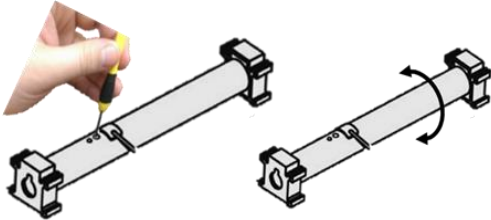

Press PROGRAM BUTTON on the motor receiver and hold until the motor jogs once.

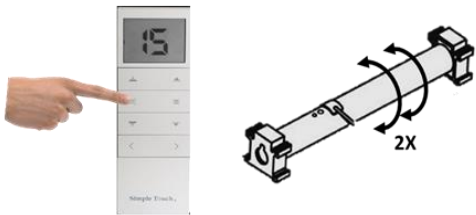

Press LEFT STOP button on remote until motor jogs twice.

## 2. Restoring Motor To Factory Settings

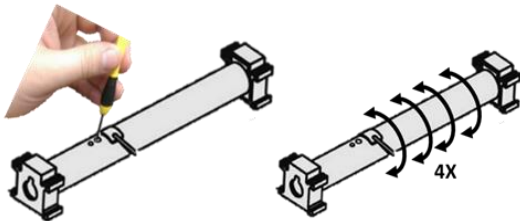

Press PROGRAM BUTTON on the motor receiver and hold until the motor jogs 4 continuous times. This ensures the motor is restored to factory settings

A hand points to the left and right arrow buttons on a remote control. The LCD screen displays the number 15.

**NOTE:** Before Programming Limit or Favorite Positions, ensure you are on the correct channel that corresponds to the shade you wish the remote to be programmed to.

Use the LEFT and RIGHT buttons to select the appropriate channel.

## 3. Setting Upper Limit Position



Press the DOWN and UP buttons to move the middle and bottom rails together until it reaches the headrail. Press the STOP button.



Press the LEFT UP and LEFT STOP buttons until the motor jogs twice.

## 4. Setting Lower Limit Position

**LOWER LIMIT MUST BE SET WITHIN 2 MINUTES AFTER COMPLETING UPPER LIMIT SETUP**



Press the LEFT DOWN button to move the bottom rail down. Click the LEFT STOP button when you reach ordered drop height.



Press the RIGHT DOWN button to move the middle rail down. Click the RIGHT STOP button when you reach the bottom rail.

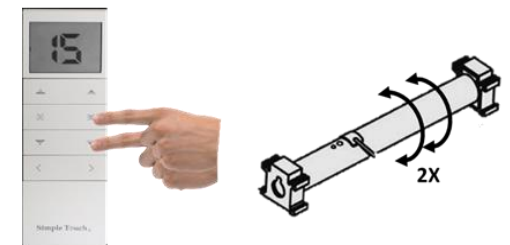

Press the RIGHT DOWN and RIGHT STOP button until the motor jogs twice.

**Note:** Channel "0" on the remote is the factory default "All" Button.