

## 5. Adding a Duplicate Remote Control



Use the **LEFT** and **RIGHT** buttons to select the shade you wish to Copy.



Press **PROGRAM BUTTON** on back of remote. Shade will jog once.



Press **PROGRAM BUTTON** on back of the remote again, and the shade will jog again.



Press **PROGRAM BUTTON** on back of the **NEW** remote, and the shade will jog again.

**Note:** Channel "0" on the remote is the factory default "All" Button.

## 6. Deleting a Duplicate Remote Control



Press **PROGRAM BUTTON** on back of remote you want to keep until the shade jogs once.



Press **PROGRAM BUTTON** on back of the remote again, and the shade will jog again.



Press **PROGRAM BUTTON** on the back of the remote **YOU WISH TO DELETE**, and the shade will jog again.

## 7. Restoring Motor To Factory Settings

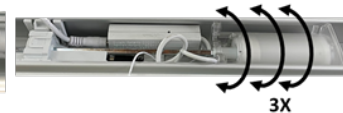

Press **PROGRAM BUTTON** on the motor receiver and hold until the motor jogs 3 continuous times. This ensures the motor is restored to factory settings

**HOME DECOR**  
WHOLESALE FABRICATORS

Made in America

# Simple Touch Motorized Cell Shade Set Up Guide

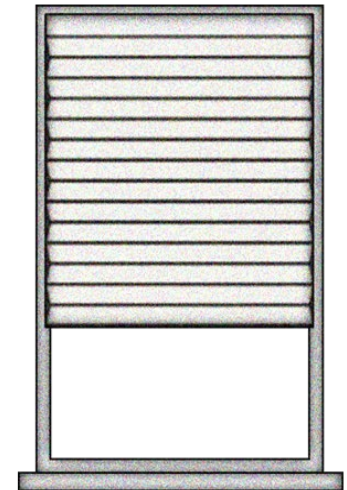

HOME DECOR WHOLESALE FABRICATORS  
602-995-9659



REV 050223

## 1. Connect Remote to Motor



Select Channel On Remote to Be Programmed Using Left and Right Buttons.

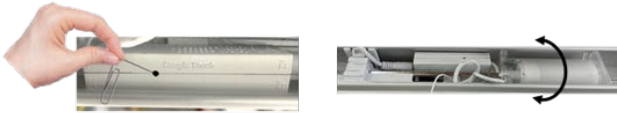

Press PROGRAM BUTTON on the motor receiver for two seconds - hold until after motor jogs once.



Press PROGRAM BUTTON on back of remote and wait for motor to jog once.



Press PROGRAM BUTON on back of remote again and wait for the motor to jog again.



Press UP button on remote to complete connection.

**Note:** Channel "0" on the remote is the factory default "All" Button.

## 2. Setting Limit Positions



### Erase All Limits

Press the UP, STOP, and DOWN buttons at the same time until you hear a long BEEP.



### Set Upper Limit

Place the shade where you want the upper limit to be set.

Press the UP and STOP buttons at the same time for 5 seconds until you hear 3 short beeps. Upper Limit is now set.



### Set Lower Limit

Place the shade where you want the lower limit to be set.

Press the DOWN and STOP buttons at the same time for 5 seconds until you hear 3 short beeps. Lower Limit is now set.



### Set Favorite Position

Place the shade where you want a favorite position to be set.

Press the STOP button for 5 seconds until you hear a short BEEP.

Then Press the STOP button again for 3 Seconds or until you hear 3 short BEEPS. Favorite Position is Now Set.

## 3. Removing Remotes from Motor



Press PROGRAM BUTTON on back of remote until shade jogs.



Press the STOP button on remote until shade jogs.



Press PROGRAM BUTTON on back of remote again until shade jogs.

## 4. Change Motor Rotation



Press the UP Button.



Press the STOP Button.

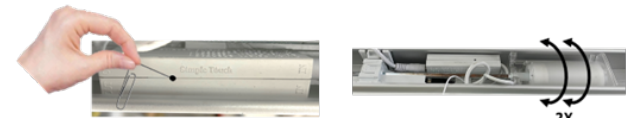

Press the Motor Receiver PROGRAM BUTTON and release it after shade jogs twice.